

# PRO SERIES ELECTRIC FRYER WASTE OIL DISPOSAL KIT 826-1999

1. Disconnect the fryer from the electrical power supply and reposition to gain access to the back.
2. Remove the screws from the bottom back panel and pull the panel away from the fryer.
3. Remove the screws from the center back panel and remove the panel from the fryer.
4. Cut the ties securing the wiring harness to the center brace. **See Figure 1**
5. Reposition the solenoid to accommodate placement of an activation rod. **See Figure 2.**

In Kit 826-1999		
Part No.	Description	Qty
106-3531	Hose Assembly	1
106-3549	Disposal Valve Assembly	1
200-5866	Bracket	1
200-5190	Brace	1
200-5867	Back, FPP, Elec, Quad	1
809-0059	Nut, Grip 1/4x20	2
809-0508	Bolt, 1/4x20x1 ¼	2
809-0412	Ty wrap	6
816-0619	Wire	1
819-5998	Instructions	1
W80C24	Wire	1
W81C19	Wire	1
802-2202	Label, waste oil	1

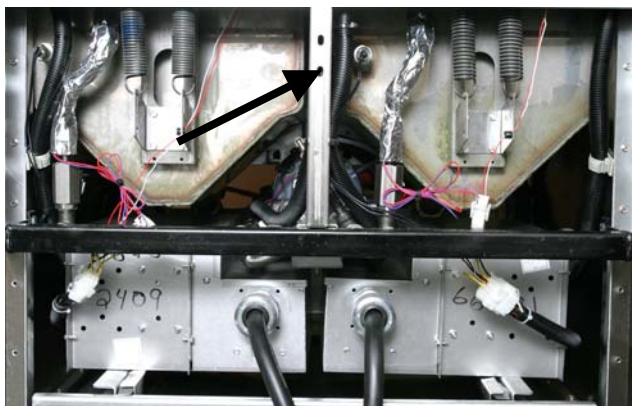
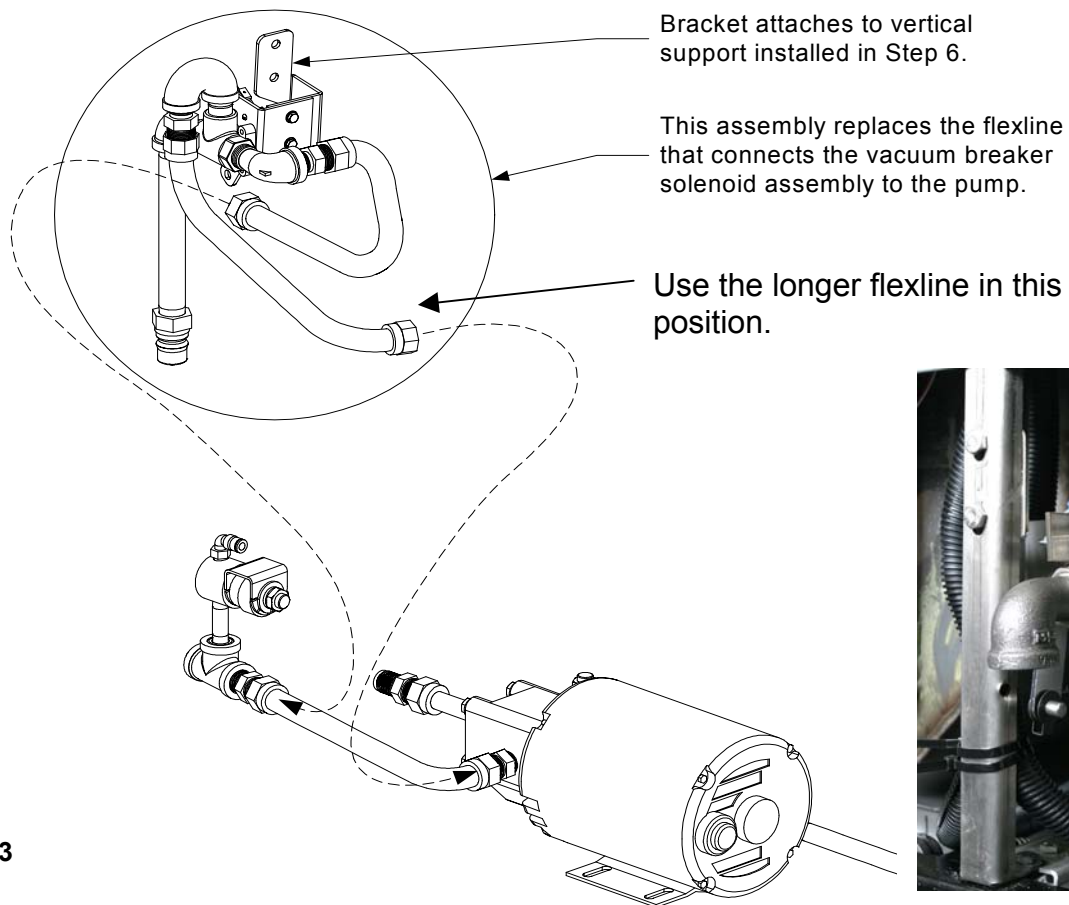

**Figure 1:** The waste-oil disposal valve will be mounted to the brace at the rear of the fryer ( See arrow).



**Figure 2:** The solenoid, visible from the rear of the fryer (see arrow), must be rotated to the left to accommodate placement of the oil disposal activation arm.

6. Disconnect the flexline that connects the right solenoid valve assembly (as viewed from the rear of the fryer) to the pump at both ends. Discard the flexline.
7. Connect the flexlines on the kit valve assembly as shown in **figure 3**. After tightening the flexline fittings, attach the assembly to the vertical support using the ¼-20 nuts and bolts furnished in the kit. Remove the downspout from the elbow, which will allow easier replacement of the fryer back. Re-attach the wire looms to the support using the wire ties furnished in the kit. The attached assembly is shown in **figure 4**.



**Figure 3**



**Figure 4:** The oil disposal valve is shown attached to the upright. The down pipe has been removed to ease replacement of the fryer back.

8. Remove the bezel, which holds the computers in place, by pushing up on the metal shroud surrounding the computers. Lower the computers and unplug the wiring harnesses from the 15-pin connectors on the back of the computers and disconnect the grounding wires from the terminals in the lower right corners of the computers.

9. Remove the two screws from the front of the component box brace (see Figures 5 and 6) and the four screws (two in the topcap on each side) that attach the component boxes to the brace. Pull the brace above the filter pan downward and out of the fryer and replace it with the one furnished in the kit.
  
10. Slip the plastic grip onto the oil disposal rod handle. Slip the rod through the hole in the brace and connect the end to the disposal valve using the clevis clip furnished in the kit. A diagram of the disposal valve and the activation rod is shown in **figure 7**.

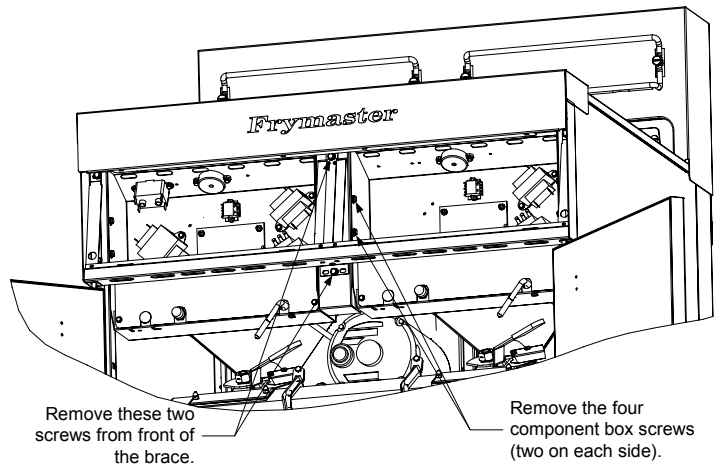

**Figure 5**



**Figure 6:** Remove the panel between the control boxes and above the filter pan.

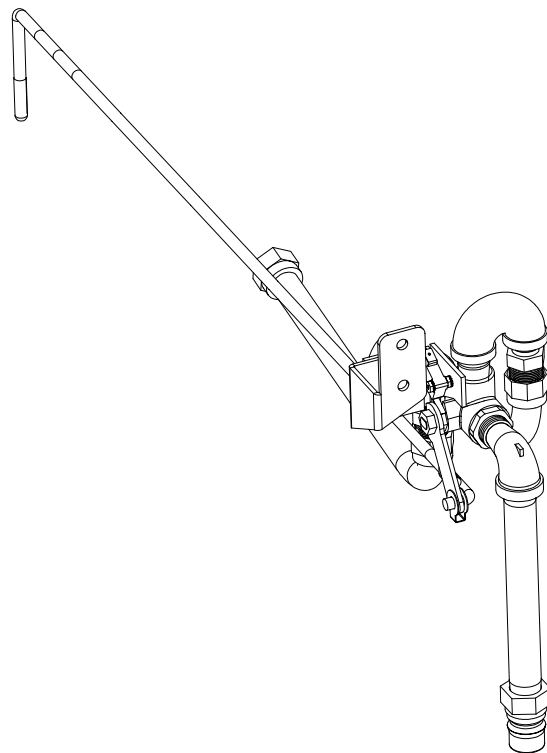

**Figure 7:** The complete disposal assembly.



11. Locate the wires and flexible conduit furnished in the kit. Connect the wires to the common and normally open posts on the oil return assembly micro switch. Thread the wiring through the fryer to the control box. See **figure 8**.

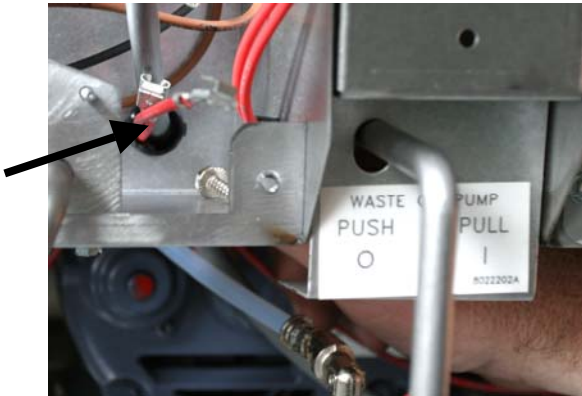

**Figure 8:** The wires for the oil disposal valve are shown routed through the control box. See arrow.

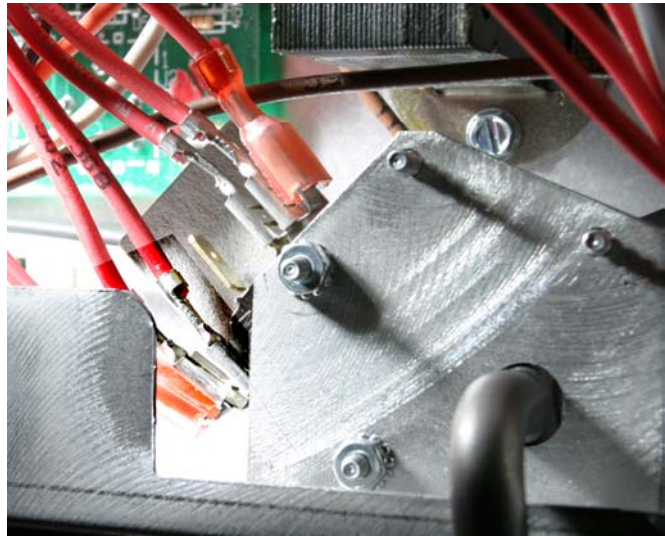

**Figure 9:** Attach the wires from the oil disposal valve switch to the oil return switch, using the provided piggyback terminals.

12. Install the wires on the left hand oil return micro switch, attaching with piggyback terminals to the common and the normally closed posts. See **figure 9**.
13. Reinstall the computer panels.
14. Install the provided lower back panel and screw the oil discharge downspout into the elbow. Position the oil discharge bracket on the downspout and fasten with screws. See **figure 10**.
15. Attach the oil discharge hose with the quick disconnect. Reposition the fryer and test the oil discharge system.



**Figure 10:** The oil discharge assembly is shown completely installed. The arrow marks the bracket used to secure the downspout.